



# VACUSERA

PRODUCT CATALOGUE

**disera**  
RESULTS OF THE SCIENTIFIC PROCESS



# INDEX

About Us	4
Production	5
VACUSERA Blood Collection Systems	6
VACUSERA Blood Collection System Components and Labeling Symbols	7
VACUSERA Blood Collection Steps	8
VACUSERA Blood Collection Tubes	9
VACUSERA Serum Clot Activator Tubes	10
VACUSERA Serum Gel & Clot Activator and Thrombin Based Serum Gel Tubes	11
VACUSERA K2Edta Tubes	12
VACUSERA K3Edta and K3Edta + Aprotinin Tubes	13
VACUSERA Coagulation Tubes	14
VACUSERA CTAD Tubes	15
VACUSERA Lithium Heparin Tubes	16
VACUSERA Sodium Heparin Tubes	17
VACUSERA No Additive Tubes	18
VACUSERA ACD-A & ACD-B Tubes	19
VACUSERA Trace Element Tubes	20
VACUSERA Crossmatch Tubes	21
VACUSERA Glucose Tubes	22
VACUSERA Blood Collection Needles	23
VACUSERA Blood Collection Accessories	24 - 25
VACUSERA Mini Capillary Blood Collection System	26 - 27
VACUSERA Sedimentation Systems	28
VACUSERA Urine Collection Systems	29
VACUSERA Blood Collection Systems Order Of Draw	30



## DISERA WAS ESTABLISHED IN 1996 AND AFTER 2003 BOTH PRODUCTION AND SALES ACTIVITIES HAVE BEEN INCREASED

Disera was established in 1996 and after 2003 both production and sales activities have been increased.

Investment in production started in 2004 and product portfolio consists of urine beakers, sharp boxes, vaginal speculum and petri dishes. In 2014 our production investment reached in a different stage by the evacuated vacuum tube production.

Vacusera evacuated blood collection tubes are the experience combined in diagnostic field and the production technology.

In 2014 we moved to our new factory building in Tire Organized Industrial Area, Izmir - TURKEY.

All products produced have the CE mark and the entire production operation is carried out in accordance with ISO 13485:2016 quality management systems and ISO 14001:2015 Environmental Management Systems.

### **OUR MISSION**

Manufacturing eco-friendly and high quality products that are appropriate for principles of medical device regulation.

Creating customers who engage with our brand.

Providing the essential equipment which will render service to increase the standard of living and community health level.

### **OUR VISION**

Being a medical device manufacturer with the highest market share and offering the variety of product range.

### **RESEARCH and DEVELOPMENT**

Tracking innovations continuously and offering the most suitable products for customers.





## PRODUCTION

Disera Tıbbi Malzeme Lojistik Sanayi ve Ticaret A.Ş having the knowledge and experience on providing quality and technical products in the medical sector, combined with the needs of the healthcare industry innovative product solutions and offers production activities according to the ISO 13485:2016 quality standards.

Vacusera Blood Collection Tubes are CE marked according to 98/79/EC In Vitro Diagnostic devices.

Vacusera Blood Collection Tubes are produced to the related standards of ISO 6710.

Vacusera Blood Collection Needles are CE certified and manufactured according to 93/42/EEC directives.

Consistent with a constantly updated technology infrastructure and experienced staff, and also the production quality assurance norms are shaped by different national and international guidelines provide the high quality level of products of DİSERA.

# VACUSERA BLOOD COLLECTION SYSTEMS

In an increased automation environment in the diagnostic laboratory field and higher standards require a continuous performance of the blood collection systems. Vacusera Blood Collection Tubes, Vacusera Blood Collection Needles and Accessories are designed according to fulfill the requirements of blood collection procedures, patient's comfort and user's safety.

Vacusera Blood Collection Tubes are made of unbreakable PET tube, butyl rubber stopper and polyethylene cap. We offer medical paper labeled tubes and also transparent labeled tubes.

All components of Vacusera Blood Collection Systems improve patient's comfort, help safe and quality blood collection and also reliable test results.



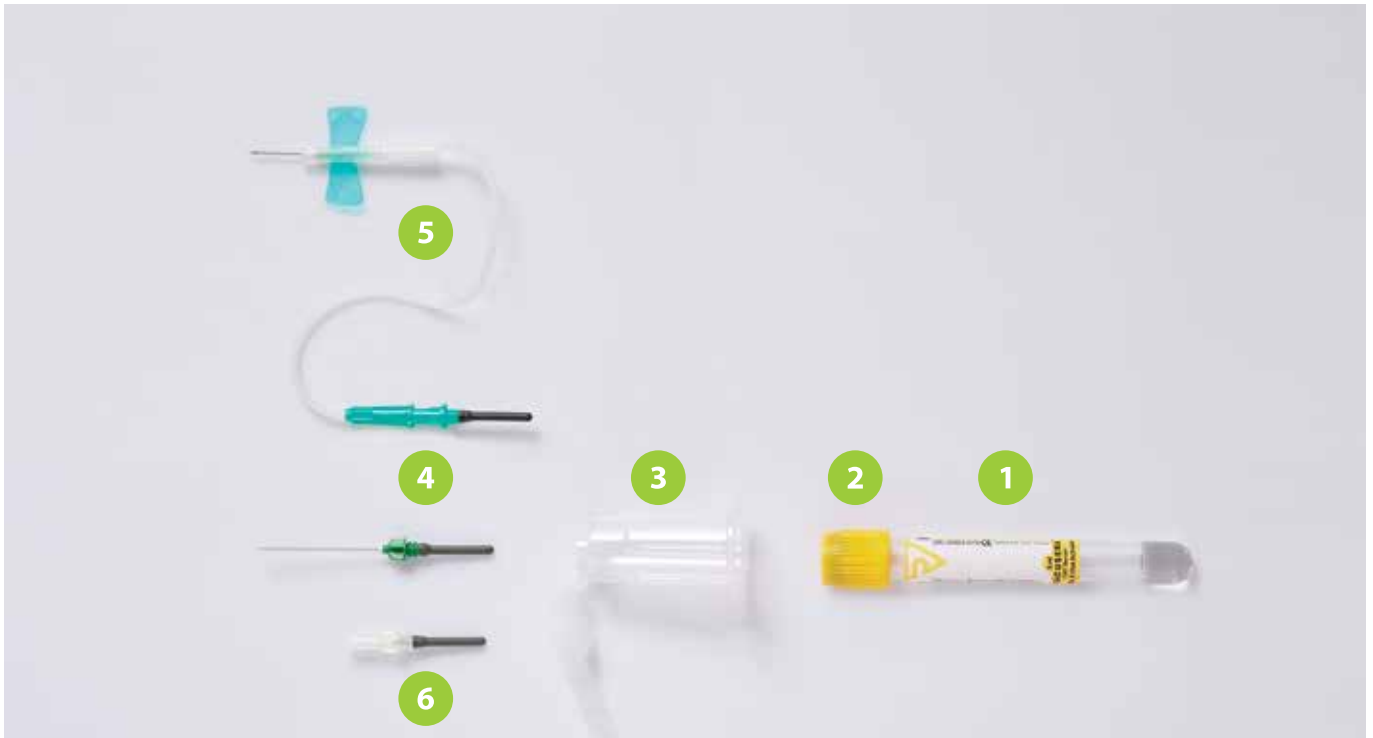

NUMBER	VACUSERA BLOOD COLLECTION COMPONENTS	LETTER CODE	ADDITIVE
1	Vacusera Blood Collection Tube	K2E	EDTA Dipotassium Salt
2	Safety Cap	K3E	EDTA Tripotassium Salt
3	Vacusera Safety Holder	9NC	Trisodium Citrate 9:1
4	Vacusera Blood Collection Needle	4NC	Trisodium Citrate 4:1
5	Vacusera Safety Blood Collection Set with Safety Shield	FE	Sodium Fluoride / EDTA
6	Vacusera Luer Adapter	FX	Sodium Fluoride/Potassium Oxalate
		LH	Lithium Heparin
		NH	Sodium Heparin
		Z	None
		CAT	Clot Activator / Clot Activator with Gel
		CTAD	Buffered Citrate 0.109 M
		ACD-A	ACD-A Solution A
		ACD-B	ACD-B Solution B

## VACUSERA BLOOD COLLECTION SYSTEM LABELLING SYMBOLS

	Do Not Reuse		Sterilized Using Ethylene oxide
	Use By-Date		Sterilized Using Irradiation
	Batch Code		CE Mark
	Reference Number		In Vitro Diagnostic Medical Device
	Date of Manufacture		Consult Instructions for Use
	Manufacturer		Temperature Limit
	Keep away from sunlight		Latex free
	Do not use if package is damaged		Do not Resterilize
	Keep Dry		Caution
	Non-pyrogenic		Non-Sterile
	Phthalate Free		Medical Device
			Single Sterile Barrier System



## BLOOD COLLECTION STEPS

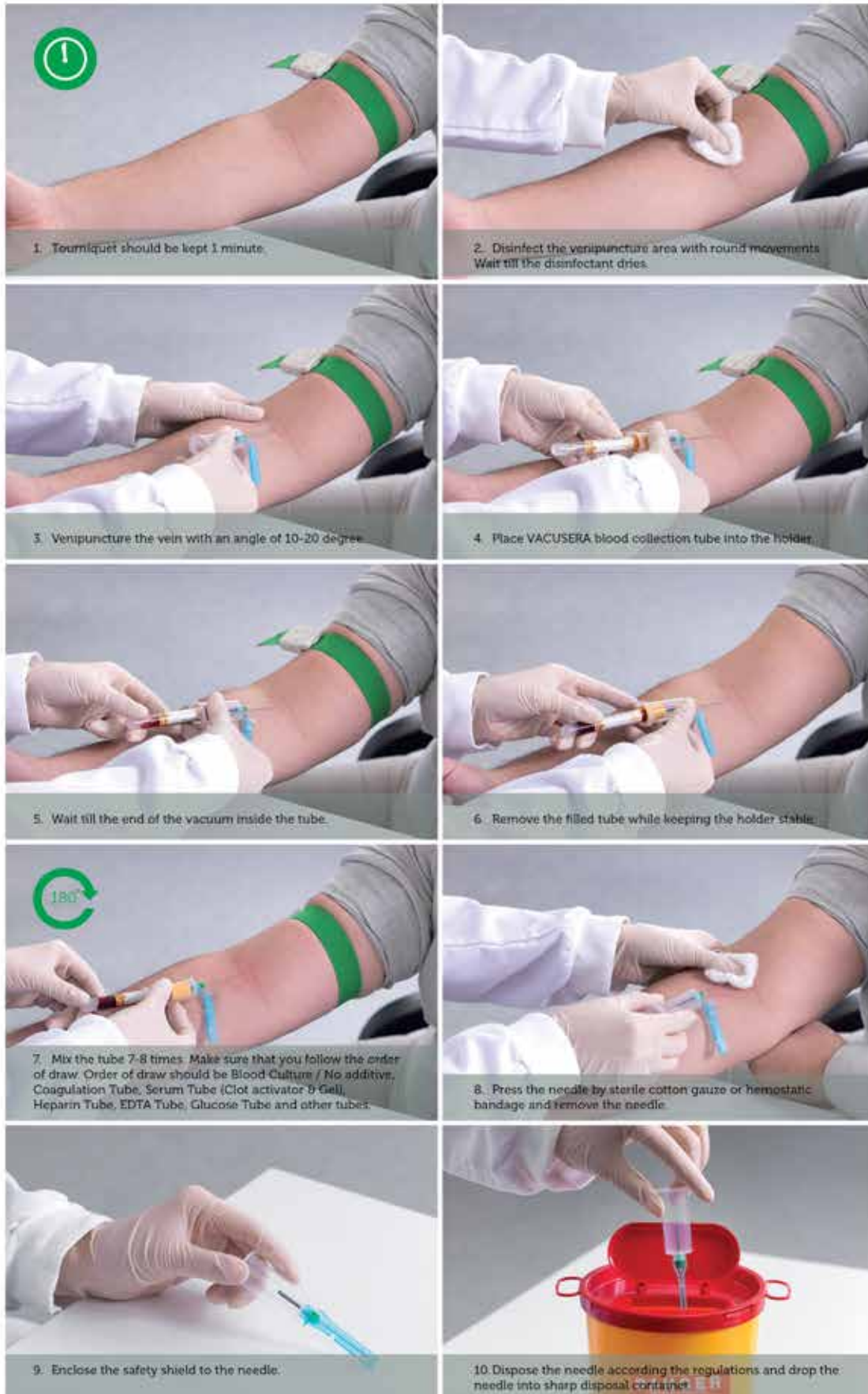





## VACUSERA BLOOD COLLECTION TUBES

Vacusera Blood Collection Tubes are made of unbreakable PET tube, butyl rubber stopper and polyethylene cap. We offer medical paper labeled tubes, transparent labeled tubes and also pre-barcoded tubes. All components of Vacusera Blood Collection Systems improve patient's comfort, help safe and quality blood collection and also reliable test results.

PAPER LABELED TUBES



TRANSPARENT LABELED TUBES



PRE-BARCODED TUBES





## VACUSERA SERUM CLOT ACTIVATOR TUBES

Vacusera Serum Clot Activator Tubes are used for clinical biochemistry and immunology. The inner wall of the Serum Clot Activator Tube is specially coated with clot activator, which activate coagulation process.

Reference Number	Description	Draw vol. (ml)	Size (mm)	Additive	Shelf life	Label Type	Pack/Carton	Cap Colour
<b>234201</b>	VACUSERA 1 ml CAT Serum Clot Activator	1	13 x 75	Clot Activator	18 months	Paper	100/1200	●
<b>234202</b>	VACUSERA 2 ml CAT Serum Clot Activator	2	13 x 75	Clot Activator	18 months	Paper	100/1200	●
<b>234203</b>	VACUSERA 3 ml CAT Serum Clot Activator	3	13 x 75	Clot Activator	18 months	Paper	100/1200	●
<b>234204</b>	VACUSERA 4 ml CAT Serum Clot Activator	4	13 x 75	Clot Activator	18 months	Paper	100/1200	●
<b>235206</b>	VACUSERA 6 ml CAT Serum Clot Activator	6	13 x 100	Clot Activator	18 months	Paper	100/1200	●
<b>236209</b>	VACUSERA 9 ml CAT Serum Clot Activator	9	16 x 100	Clot Activator	18 months	Paper	100/1200	●
<b>236200</b>	VACUSERA 10 ml CAT Serum Clot Activator	10	16 x 100	Clot Activator	18 months	Paper	100/1200	●
<b>434201</b>	VACUSERA 1 ml CAT Serum Clot Activator	1	13 x 75	Clot Activator	18 months	Transparent	100/1200	●
<b>434202</b>	VACUSERA 2 ml CAT Serum Clot Activator	2	13 x 75	Clot Activator	18 months	Transparent	100/1200	●
<b>434203</b>	VACUSERA 3 ml CAT Serum Clot Activator	3	13 x 75	Clot Activator	18 months	Transparent	100/1200	●
<b>434204</b>	VACUSERA 4 ml CAT Serum Clot Activator	4	13 x 75	Clot Activator	18 months	Transparent	100/1200	●
<b>435206</b>	VACUSERA 6 ml CAT Serum Clot Activator	6	13 x 100	Clot Activator	18 months	Transparent	100/1200	●
<b>436209</b>	VACUSERA 9 ml CAT Serum Clot Activator	9	16 x 100	Clot Activator	18 months	Transparent	100/1200	●
<b>436200</b>	VACUSERA 10 ml CAT Serum Clot Activator	10	16 x 100	Clot Activator	18 months	Transparent	100/1200	●



## VACUSERA SERUM GEL AND CLOT ACTIVATOR TUBES

Vacusera Serum Separator Tubes contain inert gel; during centrifugation, gel forms a stable barrier between serum and blood cells.

Reference Number	Description	Draw vol. (ml)	Size (mm)	Additive	Shelf life	Label Type	Pack/Carton	Cap Colour
234302	VACUSERA 2 ml CAT Serum GEL and Clot Activator	2	13 x 75	GEL + Clot Activator	18 months	Paper	100/1200	●
234304	VACUSERA 2.5 ml CAT Serum GEL and Clot Activator	2.5	13 x 75	GEL + Clot Activator	18 months	Paper	100/1200	●
234303	VACUSERA 3.5 ml CAT Serum GEL and Clot Activator	3.5	13 x 75	GEL + Clot Activator	18 months	Paper	100/1200	●
235304	VACUSERA 4 ml CAT Serum GEL and Clot Activator	4	13 x 100	GEL + Clot Activator	18 months	Paper	100/1200	●
235305	VACUSERA 5 ml CAT Serum GEL and Clot Activator	5	13 x 100	GEL + Clot Activator	18 months	Paper	100/1200	●
236308	VACUSERA 8 ml CAT Serum GEL and Clot Activator	8	16 x 100	GEL + Clot Activator	18 months	Paper	100/1200	●
236309	VACUSERA 9 ml CAT Serum GEL and Clot Activator	9	16 x 100	GEL + Clot Activator	18 months	Paper	100/1200	●
434302	VACUSERA 2 ml CAT Serum GEL and Clot Activator	2	13 x 75	GEL + Clot Activator	18 months	Transparent	100/1200	●
434304	VACUSERA 2.5 ml CAT Serum GEL and Clot Activator	2.5	13 x 75	GEL + Clot Activator	18 months	Transparent	100/1200	●
434303	VACUSERA 3.5 ml CAT Serum GEL and Clot Activator	3.5	13 x 75	GEL + Clot Activator	18 months	Transparent	100/1200	●
435304	VACUSERA 4 ml CAT Serum GEL and Clot Activator	4	13 x 100	GEL + Clot Activator	18 months	Transparent	100/1200	●
435305	VACUSERA 5 ml CAT Serum GEL and Clot Activator	5	13 x 100	GEL + Clot Activator	18 months	Transparent	100/1200	●
436308	VACUSERA 8 ml CAT Serum GEL and Clot Activator	8	16 x 100	GEL + Clot Activator	18 months	Transparent	100/1200	●
436309	VACUSERA 9 ml CAT Serum GEL and Clot Activator	9	16 x 100	GEL + Clot Activator	18 months	Transparent	100/1200	●

## VACUSERA THROMBIN BASED SERUM GEL TUBES

Vacusera thrombin based serum tubes provide rapid blood clotting by means of thrombin based clot activator and allow rapid serum separation together with the inert gel in the tubes.

Reference Number	Description	Draw vol. (ml)	Size (mm)	Additive	Shelf life	Label Type	Pack/Carton	Cap Colour
235315	VACUSERA 5 ml CAT Serum GEL and Thrombin	5	13 x 100	GEL + Clot Activator + Thrombin	12 months	Paper	100/1200	●
435315	VACUSERA 5 ml CAT Serum GEL and Thrombin	5	13 x 100	GEL + Clot Activator + Thrombin	12 months	Transparent	100/1200	●



## VACUSERA K2EDTA TUBES

Vacusera K2EDTA Tubes are for examination of whole blood in haematology. K2EDTA and GEL is mainly used for molecular diagnostics.

Reference Number	Description	Draw vol. (ml)	Size (mm)	Additive	Shelf life	Label Type	Pack/Carton	Cap Colour
234601	VACUSERA 1 ml K2E/K2Edta	1	13 x 75	K2E K2Edta	18 months	Paper	100/1200	●
234602	VACUSERA 2 ml K2E/K2Edta	2	13 x 75	K2E K2Edta	18 months	Paper	100/1200	●
234603	VACUSERA 3 ml K2E/K2Edta	3	13 x 75	K2E K2Edta	18 months	Paper	100/1200	●
234604	VACUSERA 4 ml K2E/K2Edta	4	13 x 75	K2E K2Edta	18 months	Paper	100/1200	●
234605	VACUSERA 4.5 ml K2E/K2Edta	4.5	13 x 75	K2E K2Edta	18 months	Paper	100/1200	●
235606	VACUSERA 6 ml K2E/K2Edta	6	13 x 100	K2E K2Edta	18 months	Paper	100/1200	●
236609	VACUSERA 9 ml K2E/K2Edta	9	16 x 100	K2E K2Edta	18 months	Paper	100/1200	●
434601	VACUSERA 1 ml K2E/K2Edta	1	13 x 75	K2E K2Edta	18 months	Transparent	100/1200	●
434602	VACUSERA 2 ml K2E/K2Edta	2	13 x 75	K2E K2Edta	18 months	Transparent	100/1200	●
434603	VACUSERA 3 ml K2E/K2Edta	3	13 x 75	K2E K2Edta	18 months	Transparent	100/1200	●
434604	VACUSERA 4 ml K2E/K2Edta	4	13 x 75	K2E K2Edta	18 months	Transparent	100/1200	●
434605	VACUSERA 4.5 ml K2E/K2Edta	4.5	13 x 75	K2E K2Edta	18 months	Transparent	100/1200	●
435606	VACUSERA 6 ml K2E/K2Edta	6	13 x 100	K2E K2Edta	18 months	Transparent	100/1200	●
436609	VACUSERA 9 ml K2E/K2Edta	9	16 x 100	K2E K2Edta	18 months	Transparent	100/1200	●
234623	VACUSERA 3 ml K2E/K2Edta + GEL	3	13 x 75	GEL + K2E K2Edta	18 months	Paper	100/1200	●
235625	VACUSERA 5 ml K2E/K2Edta + GEL	5	13 x 100	GEL + K2E K2Edta	18 months	Paper	100/1200	●
236628	VACUSERA 8 ml K2E/K2Edta + GEL	8	16 x 100	GEL + K2E K2Edta	18 months	Paper	100/1200	●
434623	VACUSERA 3 ml K2E/K2Edta + GEL	3	13 x 75	GEL + K2E K2Edta	18 months	Transparent	100/1200	●
435625	VACUSERA 5 ml K2E/K2Edta + GEL	5	13 x 100	GEL + K2E K2Edta	18 months	Transparent	100/1200	●
436628	VACUSERA 8 ml K2E/K2Edta + GEL	8	16 x 100	GEL + K2E K2Edta	18 months	Transparent	100/1200	●





## VACUSERA K3EDTA TUBES

Vacusera K3EDTA Tubes are for examination of whole blood in haematology.

Reference Number	Description	Draw vol. (ml)	Size (mm)	Additive	Shelf life	Label Type	Pack/Carton	Cap Colour
<b>234611</b>	VACUSERA 1 ml K3E/K3Edta	1	13 x 75	K3E K3Edta	18 months	Paper	100/1200	●
<b>234612</b>	VACUSERA 2 ml K3E/K3Edta	2	13 x 75	K3E K3Edta	18 months	Paper	100/1200	●
<b>234613</b>	VACUSERA 3 ml K3E/K3Edta	3	13 x 75	K3E K3Edta	18 months	Paper	100/1200	●
<b>234614</b>	VACUSERA 4 ml K3E/K3Edta	4	13 x 75	K3E K3Edta	18 months	Paper	100/1200	●
<b>234615</b>	VACUSERA 4.5 ml K3E/K3Edta	4.5	13 x 75	K3E K3Edta	18 months	Paper	100/1200	●
<b>235616</b>	VACUSERA 6 ml K3E/K3Edta	6	13 x 100	K3E K3Edta	18 months	Paper	100/1200	●
<b>236619</b>	VACUSERA 9 ml K3E/K3Edta	9	16 x 100	K3E K3Edta	18 months	Paper	100/1200	●
<b>434611</b>	VACUSERA 1 ml K3E/K3Edta	1	13 x 75	K3E K3Edta	18 months	Transparent	100/1200	●
<b>434612</b>	VACUSERA 2 ml K3E/K3Edta	2	13 x 75	K3E K3Edta	18 months	Transparent	100/1200	●
<b>434613</b>	VACUSERA 3 ml K3E/K3Edta	3	13 x 75	K3E K3Edta	18 months	Transparent	100/1200	●
<b>434614</b>	VACUSERA 4 ml K3E/K3Edta	4	13 x 75	K3E K3Edta	18 months	Transparent	100/1200	●
<b>434615</b>	VACUSERA 4.5 ml K3E/K3Edta	4.5	13 x 75	K3E K3Edta	18 months	Transparent	100/1200	●
<b>435616</b>	VACUSERA 6 ml K3E/K3Edta	6	13 x 100	K3E K3Edta	18 months	Transparent	100/1200	●
<b>436619</b>	VACUSERA 9 ml K3E/K3Edta	9	16 x 100	K3E K3Edta	18 months	Transparent	100/1200	●

## VACUSERA K3E/K3EDTA + APROTININ TUBES

Vacusera K3Edta + Aprotinin tubes allow us to work ACTH tests in room temperature.

Reference Number	Description	Draw vol. (ml)	Size (mm)	Additive	Shelf life	Label Type	Pack/Carton	Cap Colour
<b>234654</b>	VACUSERA 4 ml K3E/K3EDTA + Aprotinin	4	13 x 75	K3E/K3EDTA + Aprotinin	12 months	Paper	100/1200	●
<b>434654</b>	VACUSERA 4 ml K3E/K3EDTA + Aprotinin	4	13 x 75	K3E/K3EDTA + Aprotinin	12 months	Transparent	100/1200	●



## VACUSERA COAGULATION TUBES

Vacusera Coagulation Tubes are used for blood coagulation tests. Coagulation Tubes have a buffered sodium citrate solution of 0.109 mol/l (3.2%) or 0.129 mol/l (3.8 %). Double Tube (\*DT) technology provides an excellent condition for coagulation tests.

### VACUSERA 9NC COAGULATION SODIUM CITRATE 3.2%

Reference Number	Description	Draw vol. (ml)	Size (mm)	Additive	Shelf life	Label Type	Pack /Carton	Cap Colour
234501	VACUSERA 1 ml Coagulation 3.2% Sodium Citrate - DT	1	13 x 75	9NC Sodium Citrate 3.2%(0.109M)	9 months	Paper	100/1200	●
234502	VACUSERA 1.8 ml Coagulation 3.2% Sodium Citrate - DT	1.8	13 x 75	9NC Sodium Citrate 3.2%(0.109M)	9 months	Paper	100/1200	●
234503	VACUSERA 2.7 ml Coagulation 3.2% Sodium Citrate - DT	2.7	13 x 75	9NC Sodium Citrate 3.2%(0.109M)	9 months	Paper	100/1200	●
234504	VACUSERA 3.6 ml Coagulation 3.2% Sodium Citrate	3.6	13 x 75	9NC Sodium Citrate 3.2%(0.109M)	4 months	Paper	100/1200	●
234505	VACUSERA 4.5 ml Coagulation 3.2% Sodium Citrate	4.5	13 x 75	9NC Sodium Citrate 3.2%(0.109M)	4 months	Paper	100/1200	●
235505	VACUSERA 5 ml Coagulation 3.2% Sodium Citrate	5	13 x 100	9NC Sodium Citrate 3.2%(0.109M)	4 months	Paper	100/1200	●
434501	VACUSERA 1 ml Coagulation 3.2% Sodium Citrate - DT	1	13 x 75	9NC Sodium Citrate 3.2%(0.109M)	9 months	Transparent	100/1200	●
434502	VACUSERA 1.8 ml Coagulation 3.2% Sodium Citrate - DT	1.8	13 x 75	9NC Sodium Citrate 3.2%(0.109M)	9 months	Transparent	100/1200	●
434503	VACUSERA 2.7 ml Coagulation 3.2% Sodium Citrate - DT	2.7	13 x 75	9NC Sodium Citrate 3.2%(0.109M)	9 months	Transparent	100/1200	●
434504	VACUSERA 3.6 ml Coagulation 3.2% Sodium Citrate	3.6	13 x 75	9NC Sodium Citrate 3.2%(0.109M)	4 months	Transparent	100/1200	●
434505	VACUSERA 4.5 ml Coagulation 3.2% Sodium Citrate	4.5	13 x 75	9NC Sodium Citrate 3.2%(0.109M)	4 months	Transparent	100/1200	●
435505	VACUSERA 5 ml Coagulation 3.2% Sodium Citrate	5	13 x 100	9NC Sodium Citrate 3.2%(0.109M)	4 months	Transparent	100/1200	●

### VACUSERA 9NC COAGULATION SODIUM CITRATE 3.8%

Reference Number	Description	Draw vol. (ml)	Size (mm)	Additive	Shelf life	Label Type	Pack /Carton	Cap Colour
234511	VACUSERA 1 ml Coagulation 3.8% Sodium Citrate - DT	1	13 x 75	9NC Sodium Citrate %3.8(0.129M)	9 months	Paper	100/1200	●
234512	VACUSERA 1.8 ml Coagulation 3.8% Sodium Citrate - DT	1.8	13 x 75	9NC Sodium Citrate %3.8(0.129M)	9 months	Paper	100/1200	●
234513	VACUSERA 2.7 ml Coagulation 3.8% Sodium Citrate - DT	2.7	13 x 75	9NC Sodium Citrate %3.8(0.129M)	9 months	Paper	100/1200	●
234514	VACUSERA 3.6 ml Coagulation 3.8% Sodium Citrate	3.6	13 x 75	9NC Sodium Citrate %3.8(0.129M)	4 months	Paper	100/1200	●
234515	VACUSERA 4.5 ml Coagulation 3.8% Sodium Citrate	4.5	13 x 75	9NC Sodium Citrate %3.8(0.129M)	4 months	Paper	100/1200	●
235515	VACUSERA 5 ml Coagulation 3.8% Sodium Citrate	5	13 x 100	9NC Sodium Citrate %3.8(0.129M)	4 months	Paper	100/1200	●
434511	VACUSERA 1 ml Coagulation 3.8% Sodium Citrate - DT	1	13 x 75	9NC Sodium Citrate %3.8(0.129M)	9 months	Transparent	100/1200	●
434512	VACUSERA 1.8 ml Coagulation 3.8% Sodium Citrate - DT	1.8	13 x 75	9NC Sodium Citrate %3.8(0.129M)	9 months	Transparent	100/1200	●
434513	VACUSERA 2.7 ml Coagulation 3.8% Sodium Citrate - DT	2.7	13 x 75	9NC Sodium Citrate %3.8(0.129M)	9 months	Transparent	100/1200	●
434514	VACUSERA 3.6 ml Coagulation 3.8% Sodium Citrate	3.6	13 x 75	9NC Sodium Citrate %3.8(0.129M)	4 months	Transparent	100/1200	●
434515	VACUSERA 4.5 ml Coagulation 3.8% Sodium Citrate	4.5	13 x 75	9NC Sodium Citrate %3.8(0.129M)	4 months	Transparent	100/1200	●
435515	VACUSERA 5 ml Coagulation 3.8% Sodium Citrate	5	13 x 100	9NC Sodium Citrate %3.8(0.129M)	4 months	Transparent	100/1200	●

\*DT: Double Tube



## VACUSERA CTAD TUBES

Vacusera CTAD Tubes are used for coagulation tests. Buffered Citrate Solution consists Theophylline Adenosine, Dipyridamole. CTAD Tubes are used for reliable test results by preventing activation of in vitro thrombocyte.

Reference Number	Description	Draw vol. (ml)	Size (mm)	Additive	Shelf life	Label Type	Pack /Carton	Cap Colour
<b>234522</b>	VACUSERA 1.8 ml CTAD - DT	1.8	13 x 75	Buffered Sodium Citrate 3.2% (0.109)	9 months	Paper	100/1200	●
<b>234523</b>	VACUSERA 2.7 ml CTAD - DT	2.7	13 x 75	Buffered Sodium Citrate 3.2% (0.109)	9 months	Paper	100/1200	●
<b>234524</b>	VACUSERA 3.6 ml CTAD	3.6	13 x 75	Buffered Sodium Citrate 3.2% (0.109)	4 months	Paper	100/1200	●
<b>234525</b>	VACUSERA 4.5 ml CTAD	4.5	13 x 75	Buffered Sodium Citrate 3.2% (0.109)	4 months	Paper	100/1200	●
<b>434522</b>	VACUSERA 1.8 ml CTAD - DT	1.8	13 x 75	Buffered Sodium Citrate 3.2% (0.109)	9 months	Transparent	100/1200	●
<b>434523</b>	VACUSERA 2.7 ml CTAD - DT	2.7	13 x 75	Buffered Sodium Citrate 3.2% (0.109)	9 months	Transparent	100/1200	●
<b>434524</b>	VACUSERA 3.6 ml CTAD	3.6	13 x 75	Buffered Sodium Citrate 3.2% (0.109)	4 months	Transparent	100/1200	●
<b>434525</b>	VACUSERA 4.5 ml CTAD	4.5	13 x 75	Buffered Sodium Citrate 3.2% (0.109)	4 months	Transparent	100/1200	●

DT: Double Tube



## VACUSERA HEPARIN TUBES

Vacusera Heparin Tubes are coated with Lithium Heparin or Sodium Heparin to inhibit clotting. Sodium Heparin or Lithium Heparin Tubes are used for plasma determinations in clinical chemistry. Heparin Tubes are also available with gel separator.

## VACUSERA LH LITHIUM HEPARIN TUBES

Reference Number	Description	Draw vol. (ml)	Size (mm)	Additive	Shelf life	Label Type	Pack /Carton	Cap Colour
<b>234402</b>	VACUSERA 2 ml LH/Lithium Heparin	2	13 x 75	LH/Lithium Heparin	18 months	Paper	100/1200	●
<b>234404</b>	VACUSERA 4 ml LH/Lithium Heparin	4	13 x 75	LH/Lithium Heparin	18 months	Paper	100/1200	●
<b>235406</b>	VACUSERA 6 ml LH/Lithium Heparin	6	13 x 100	LH/Lithium Heparin	18 months	Paper	100/1200	●
<b>236409</b>	VACUSERA 9 ml LH/Lithium Heparin	9	16 x 100	LH/Lithium Heparin	18 months	Paper	100/1200	●
<b>434402</b>	VACUSERA 2 ml LH/Lithium Heparin	2	13 x 75	LH/Lithium Heparin	18 months	Transparent	100/1200	●
<b>434404</b>	VACUSERA 4 ml LH/Lithium Heparin	4	13 x 75	LH/Lithium Heparin	18 months	Transparent	100/1200	●
<b>435406</b>	VACUSERA 6 ml LH/Lithium Heparin	6	13 x 100	LH/Lithium Heparin	18 months	Transparent	100/1200	●
<b>436409</b>	VACUSERA 9 ml LH/Lithium Heparin	9	16 x 100	LH/Lithium Heparin	18 months	Transparent	100/1200	●
<b>234413</b>	VACUSERA 3 ml LH/Lithium Heparin + GEL	3	13 x 75	GEL + LH/Lithium Heparin	18 months	Paper	100/1200	●
<b>235415</b>	VACUSERA 5 ml LH/Lithium Heparin + GEL	5	13 x 100	GEL + LH/Lithium Heparin	18 months	Paper	100/1200	●
<b>236418</b>	VACUSERA 8 ml LH/Lithium Heparin + GEL	8	16 x 100	GEL + LH/Lithium Heparin	18 months	Paper	100/1200	●
<b>434413</b>	VACUSERA 3 ml LH/Lithium Heparin + GEL	3	13 x 75	GEL + LH/Lithium Heparin	18 months	Transparent	100/1200	●
<b>435415</b>	VACUSERA 5 ml LH/Lithium Heparin + GEL	5	13 x 100	GEL + LH/Lithium Heparin	18 months	Transparent	100/1200	●
<b>436418</b>	VACUSERA 8 ml LH/Lithium Heparin + GEL	8	16 x 100	GEL + LH/Lithium Heparin	18 months	Transparent	100/1200	●





## VACUSERA NH SODIUM HEPARIN TUBES

Vacusera Sodium Heparin Tubes are used for plasma determinations in clinical chemistry.

### VACUSERA NH SODIUM HEPARIN

Reference Number	Description	Draw vol. (ml)	Size (mm)	Additive	Shelf life	Label Type	Pack /Carton	Cap Colour
<b>234424</b>	VACUSERA 4 ml NH/Sodium Heparin	4	13 x 75	NH/Sodium Heparin	18 months	Paper	100/1200	●
<b>235426</b>	VACUSERA 6 ml NH/Sodium Heparin	6	13 x 100	NH/Sodium Heparin	18 months	Paper	100/1200	●
<b>236429</b>	VACUSERA 9 ml NH/Sodium Heparin	9	16 x 100	NH/Sodium Heparin	18 months	Paper	100/1200	●
<b>434424</b>	VACUSERA 4 ml NH/Sodium Heparin	4	13 x 75	NH/Sodium Heparin	18 months	Transparent	100/1200	●
<b>435426</b>	VACUSERA 6 ml NH/Sodium Heparin	6	13 x 100	NH/Sodium Heparin	18 months	Transparent	100/1200	●
<b>436429</b>	VACUSERA 9 ml NH/Sodium Heparin	9	16 x 100	NH/Sodium Heparin	18 months	Transparent	100/1200	●
<b>234433</b>	VACUSERA 3 ml NH/Sodium Heparin + GEL	3	13 x 75	GEL + Sodium Heparin	18 months	Paper	100/1200	●
<b>235435</b>	VACUSERA 5 ml NH/Sodium Heparin + GEL	5	13 x 100	GEL + Sodium Heparin	18 months	Paper	100/1200	●
<b>236438</b>	VACUSERA 8 ml NH/Sodium Heparin + GEL	8	16 x 100	GEL + Sodium Heparin	18 months	Paper	100/1200	●
<b>434433</b>	VACUSERA 3 ml NH/Sodium Heparin + GEL	3	13 x 75	GEL + Sodium Heparin	18 months	Transparent	100/1200	●
<b>435435</b>	VACUSERA 5 ml NH/Sodium Heparin + GEL	5	13 x 100	GEL + Sodium Heparin	18 months	Transparent	100/1200	●
<b>436438</b>	VACUSERA 8 ml NH/Sodium Heparin + GEL	8	16 x 100	GEL + Sodium Heparin	18 months	Transparent	100/1200	●



## VACUSERA NO ADDITIVE TUBES

Vacusera No Additive tube do not contain any additives and are used for collecting Cerebrospinal Fluid.

Reference Number	Description	Draw vol. (ml)	Size (mm)	Additive	Shelf life	Label Type	Pack/Carton	Cap Colour
<b>234102</b>	VACUSERA 2 ml Z No Additive	2	13 x 75	No Additive	18 months	Paper	100/1200	○
<b>234104</b>	VACUSERA 4 ml Z No Additive	4	13 x 75	No Additive	18 months	Paper	100/1200	○
<b>235106</b>	VACUSERA 6 ml Z No Additive	6	13 x 100	No Additive	18 months	Paper	100/1200	○
<b>236109</b>	VACUSERA 9 ml Z No Additive	9	16 x 100	No Additive	18 months	Paper	100/1200	○
<b>236100</b>	VACUSERA 10 ml Z No Additive	10	16 x 100	No Additive	18 months	Paper	100/1200	○
<b>434102</b>	VACUSERA 2 ml Z No Additive	2	13 x 75	No Additive	18 months	Transparent	100/1200	○
<b>434104</b>	VACUSERA 4 ml Z No Additive	4	13 x 75	No Additive	18 months	Transparent	100/1200	○
<b>435106</b>	VACUSERA 6 ml Z No Additive	6	13 x 100	No Additive	18 months	Transparent	100/1200	○
<b>436109</b>	VACUSERA 9 ml Z No Additive	9	16 x 100	No Additive	18 months	Transparent	100/1200	○
<b>436100</b>	VACUSERA 10 ml Z No Additive	10	16 x 100	No Additive	18 months	Transparent	100/1200	○



## VACUSERA ACD-A & ACD-B TUBES

Vacusera Blood Grouping Tubes contain 2 formulations as ACD-A & ACD-B solutions and are used in Blood Grouping.

Reference Number	Description	Draw vol. (ml)	Size (mm)	Additive	Shelf life	Label Type	Pack/Carton	Cap Colour
<b>235726</b>	VACUSERA 6 ML ACD-A	6	13 x 100	ACD-A	12 months	Paper	100/1200	●
<b>236729</b>	VACUSERA 9 ML ACD-A	9	16 x 100	ACD-A	12 months	Paper	100/1200	●
<b>235736</b>	VACUSERA 6 ML ACD-B	6	13 x 100	ACD-B	12 months	Paper	100/1200	●
<b>236739</b>	VACUSERA 9 ML ACD-B	9	16 x 100	ACD-B	12 months	Paper	100/1200	●
<b>435726</b>	VACUSERA 6 ML ACD-A	6	13 x 100	ACD-A	12 months	Transparent	100/1200	●
<b>436729</b>	VACUSERA 9 ML ACD-A	9	16 x 100	ACD-A	12 months	Transparent	100/1200	●
<b>435736</b>	VACUSERA 6 ML ACD-B	6	13 x 100	ACD-B	12 months	Transparent	100/1200	●
<b>436739</b>	VACUSERA 9 ML ACD-B	9	16 x 100	ACD-B	12 months	Transparent	100/1200	●



## VACUSERA TRACE ELEMENT TUBES

Vacusera Trace Element tubes are used for determining the elements of Iron, Zinc, Copper, Mercury and Lead. Tubes consist Clot Activator, K2Edta or Sodium Heparin.

Reference Number	Description	Draw vol. (ml)	Size (mm)	Additive	Shelf life	Label Type	Pack/Carton	Cap Colour
<b>235006</b>	VACUSERA 6 ml Trace Element CAT Serum Clot Activator	6	13 x 100	Clot Activator	18 months	Paper	100/1200	●
<b>235016</b>	VACUSERA 6 ml Trace Element NH/Sodium Heparin	6	13 x 100	Sodium Heparin	18 months	Paper	100/1200	●
<b>235026</b>	VACUSERA 6 ml Trace Element K2E/K2Edta	6	13 x 100	K2Edta	18 months	Paper	100/1200	●
<b>435006</b>	VACUSERA 6 ml Trace Element CAT Serum Clot Activator	6	13 x 100	Clot Activator	18 months	Transparent	100/1200	●
<b>435016</b>	VACUSERA 6 ml Trace Element NH/Sodium Heparin	6	13 x 100	Sodium Heparin	18 months	Transparent	100/1200	●
<b>435026</b>	VACUSERA 6 ml Trace Element K2E/K2Edta	6	13 x 100	K2Edta	18 months	Transparent	100/1200	●





## VACUSERA CROSSMATCH TUBES

Vacusera Crossmatch tubes contain silica particles as clot activator and K2EDTA / K3EDTA as anticoagulant.

Reference Number	Description	Draw vol. (ml)	Size (mm)	Additive	Shelf life	Label Type	Pack/Carton	Cap Colour
<b>235216</b>	VACUSERA 6 ml Crossmatch CAT Serum Clot Activator	6	13 x 100	Clot Activator	18 months	Paper	100/1200	●
<b>236219</b>	VACUSERA 9 ml Crossmatch CAT Serum Clot Activator	9	16 x 100	Clot Activator	18 months	Paper	100/1200	●
<b>234634</b>	VACUSERA 4 ml Crossmatch K2E/K2 Edta	4	13 x 75	K2 Edta	18 months	Paper	100/1200	●
<b>235636</b>	VACUSERA 6 ml Crossmatch K2E/K2 Edta	6	13 x 100	K2 Edta	18 months	Paper	100/1200	●
<b>234644</b>	VACUSERA 4 ml Crossmatch K3E/K3 Edta	4	13 x 75	K3 Edta	18 months	Paper	100/1200	●
<b>235646</b>	VACUSERA 6 ml Crossmatch K3E/K3 Edta	6	13 x 100	K3 Edta	18 months	Paper	100/1200	●
<b>435216</b>	VACUSERA 6 ml Crossmatch CAT Serum Clot Activator	6	13 x 100	Clot Activator	18 months	Transparent	100/1200	●
<b>436219</b>	VACUSERA 9 ml Crossmatch CAT Serum Clot Activator	9	16 x 100	Clot Activator	18 months	Transparent	100/1200	●
<b>434634</b>	VACUSERA 4 ml Crossmatch K2E/K2 Edta	4	13 x 75	K2 Edta	18 months	Transparent	100/1200	●
<b>435636</b>	VACUSERA 6 ml Crossmatch K2E/K2 Edta	6	13 x 100	K2 Edta	18 months	Transparent	100/1200	●
<b>434644</b>	VACUSERA 4 ml Crossmatch K3E/K3 Edta	4	13 x 75	K3 Edta	18 months	Transparent	100/1200	●
<b>435646</b>	VACUSERA 6 ml Crossmatch K3E/K3 Edta	6	13 x 100	K3 Edta	18 months	Transparent	100/1200	●



## VACUSERA GLUCOSE TUBES

Vacusera Glucose Tubes contain Sodium Fluoride and K3 EDTA, Sodium Fluoride and Potassium Oxalate and also Sodium Fluoride + Na<sub>2</sub> Edta. Glucose tubes are used for glucose determinations like blood sugar, sugar tolerance, etanol and alcohol ratio in blood.

### VACUSERA FE/SODIUM FLUORIDE + K3EDTA

Reference Number	Description	Draw vol. (ml)	Size (mm)	Additive	Shelf life	Label Type	Pack/ Carton	Cap Colour
<b>234702</b>	VACUSERA 2 ml FE/Sodium Fluoride + K3EDTA	2	13 x 75	FE/Sodium Fluoride + K3EDTA	18 months	Paper	100/1200	●
<b>234704</b>	VACUSERA 4 ml FE/Sodium Fluoride + K3EDTA	4	13 x 75	FE/Sodium Fluoride + K3EDTA	18 months	Paper	100/1200	●
<b>434702</b>	VACUSERA 2 ml FE/Sodium Fluoride + K3EDTA	2	13 x 75	FE/Sodium Fluoride + K3EDTA	18 months	Transparent	100/1200	●
<b>434704</b>	VACUSERA 4 ml FE/Sodium Fluoride + K3EDTA	4	13 x 75	FE/Sodium Fluoride + K3EDTA	18 months	Transparent	100/1200	●

### VACUSERA FX/SODIUM FLUORIDE + POTASSIUM OXALATE

Reference Number	Description	Draw vol. (ml)	Size (mm)	Additive	Shelf life	Label Type	Pack/ Carton	Cap Colour
<b>234712</b>	VACUSERA 2 ml FX/Sodium Fluoride + Potassium Oxalate	2	13 x 75	FX/Sodium Fluoride + Potassium Oxalate	18 months	Paper	100/1200	●
<b>234714</b>	VACUSERA 4 ml FX/Sodium Fluoride + Potassium Oxalate	4	13 x 75	FX/Sodium Fluoride + Potassium Oxalate	18 months	Paper	100/1200	●
<b>434712</b>	VACUSERA 2 ml FX/Sodium Fluoride + Potassium Oxalate	2	13 x 75	FX/Sodium Fluoride + Potassium Oxalate	18 months	Transparent	100/1200	●
<b>434714</b>	VACUSERA 4 ml FX/Sodium Fluoride + Potassium Oxalate	4	13 x 75	FX/Sodium Fluoride + Potassium Oxalate	18 months	Transparent	100/1200	●

### VACUSERA FE/SODIUM FLUORIDE+NA<sub>2</sub> EDTA

Reference Number	Description	Draw vol. (ml)	Size (mm)	Additive	Shelf life	Label Type	Pack/ Carton	Cap Colour
<b>234722</b>	VACUSERA 2 ml FE/Sodium Fluoride + NA <sub>2</sub> EDTA	2	13 x 75	FE/Sodium Fluoride + NA <sub>2</sub> EDTA	18 months	Paper	100/1200	●
<b>234724</b>	VACUSERA 4 ml FE/Sodium Fluoride + NA <sub>2</sub> EDTA	4	13 x 75	FE/Sodium Fluoride + NA <sub>2</sub> EDTA	18 months	Paper	100/1200	●
<b>235725</b>	VACUSERA 5 ml FE/Sodium Fluoride + NA <sub>2</sub> EDTA	5	13 x 100	FE/Sodium Fluoride + NA <sub>2</sub> EDTA	18 months	Paper	100/1200	●
<b>434722</b>	VACUSERA 2 ml FE/Sodium Fluoride + NA <sub>2</sub> EDTA	2	13 x 75	FE/Sodium Fluoride + NA <sub>2</sub> EDTA	18 months	Transparent	100/1200	●
<b>434724</b>	VACUSERA 4 ml FE/Sodium Fluoride + NA <sub>2</sub> EDTA	4	13 x 75	FE/Sodium Fluoride + NA <sub>2</sub> EDTA	18 months	Transparent	100/1200	●
<b>435725</b>	VACUSERA 5 ml FE/Sodium Fluoride + NA <sub>2</sub> EDTA	5	13 x 100	FE/Sodium Fluoride + NA <sub>2</sub> EDTA	18 months	Transparent	100/1200	●



## VACUSERA BLOOD COLLECTION NEEDLES

Vacuse Blood Colletion Needles are used in blood collection, single-used and sterile. The needles are coated with silicone, a low friction and ensuring very soft vein entry.

The colour of needle hub identifies needle gauge.

Vacusera Blood Colletion Needles are also available with integrated safety cap and window (Vision).

Reference Number	Description	Size	Pack/Carton	Colour
<b>250018K</b>	Blood Collection Needle 18 G	18 G x 1 1/2" (1.2x38mm)	100/5000	●
<b>250020K</b>	Blood Collection Needle 20 G	20 G x 1 1/2" (0.9x38mm)	100/5000	●
<b>250021K</b>	Blood Collection Needle 21 G	21 G x 1 1/2" (0.8x38mm)	100/5000	●
<b>250022K</b>	Blood Collection Needle 22 G	22 G x 1 1/2" (0.7x38mm)	100/5000	●
<b>252020</b>	Luer Adapter 20 G	20 G	100/5000	●
<b>255021K</b>	Blood Collection Needle 21 G - VISION	21 G x 1 1/2" (0.8x38mm)	100/5000	●
<b>255022K</b>	Blood Collection Needle 22 G - VISION	22 G x 1 1/2" (0.7x38mm)	100/5000	●
<b>251021K</b>	Integrated Safety Needle 21 G	21 G x 1 1/4" (0.8x32mm)	48/2400	●
<b>251022K</b>	Integrated Safety Needle 22 G	22 G x 1 1/4" (0.7x32mm)	48/2400	●
<b>253021K</b>	Blood Collection Needle 21 G	21 G x 1" (0.8x25mm)	100/5000	●
<b>253022K</b>	Blood Collection Needle 22 G	22 G x 1" (0.7x25mm)	100/5000	●
<b>261021K</b>	Needle Vision + Safety Holder 21 G	21 G x 1 1/2" (0.8x38mm)	24/192	●
<b>261022K</b>	Needle Vision + Safety Holder 22 G	22 G x 1 1/2" (0.7x38mm)	24/192	●

## VACUSERA ACCESSORIES

Vacusera Accessories provide necessary products for blood collection.

### BLOOD COLLECTION NEEDLES + SAFETY HOLDER



Reference Number	Description	Pack/Carton
<b>260018K</b>	Blood Collection Needle + Safety Holder 18 G x 1 1/2" (1.2x38mm)	25/500
<b>260020K</b>	Blood Collection Needle + Safety Holder 20 G x 1 1/2" (0.9x38mm)	25/500
<b>260021K</b>	Blood Collection Needle + Safety Holder 21 G x 1 1/2" (0.8x38mm)	25/500
<b>260022K</b>	Blood Collection Needle + Safety Holder 22 G x 1 1/2" (0.7x38mm)	25/500
<b>260023K</b>	Blood Collection Needle + Safety Holder 23 G x 1 1/2" (0.6x38mm)	25/500

### HOLDERS

Vacusera Holders are compatible with Vacusera Blood Collection Needles and Vacusera Blood Collection Tubes. It provides safety and easy use for healthcare workers.



Reference Number	Description	Pack/Carton
<b>260001</b>	Blood Collection Needle Holder	200/1000
<b>260002</b>	Safety Holder	200/800
<b>260003</b>	Automatic Holder	200/800
<b>260004</b>	Blood Collection Holder with Female Luer Lock	200/800
<b>260005</b>	Blood Collection Holder with Male Luer Lock	200/800
<b>260006K</b>	Luer Adapter + Blood Collection Needle Holder	200/800

### BLOOD COLLECTION SETS WITH SAFETY SHIELD

Vacusera Safety Blood Collection Sets are used for blood collection from difficult veins like children and elder people. Safety mechanism protects healthcare workers from needle stick injury.



Reference Number	Description	Size (mm)	Pack/ Carton	Colour
<b>24121190K</b>	Blood Collection Set with Safety Shield 21 G 3/4" x 7"	0.8 x 19mm x 180mm	100/2000	●
<b>24121300K</b>	Blood Collection Set with Safety Shield 21 G 3/4" x 12"	0.8 x 19mm x 305mm	100/2000	●
<b>24122190K</b>	Blood Collection Set with Safety Shield 22 G 3/4" x 7"	0.7 x 19mm x 180mm	100/2000	●
<b>24122300K</b>	Blood Collection Set with Safety Shield 22 G 3/4" x 12"	0.7 x 19mm x 305mm	100/2000	●
<b>24123190K</b>	Blood Collection Set with Safety Shield 23 G 3/4" x 7"	0.6 x 19mm x 180mm	100/2000	●
<b>24123300K</b>	Blood Collection Set with Safety Shield 23 G 3/4" x 12"	0.6 x 19mm x 305mm	100/2000	●
<b>24125190K</b>	Blood Collection Set with Safety Shield 25 G 3/4" x 7"	0.5 x 19mm x 180mm	100/2000	●
<b>24125300K</b>	Blood Collection Set with Safety Shield 25 G 3/4" x 12"	0.5 x 19mm x 305mm	100/2000	●
<b>24121190G</b>	Blood Collection Set with Safety Shield 21 G 3/4" x 7.5"	0.8 x 20mm x 190mm	100/900	●
<b>24121300G</b>	Blood Collection Set with Safety Shield 21 G 3/4" x 12"	0.8 x 20mm x 300mm	100/900	●
<b>24123190G</b>	Blood Collection Set with Safety Shield 23 G 3/4" x 7.5"	0.6 x 20mm x 190mm	100/900	●
<b>24123300G</b>	Blood Collection Set with Safety Shield 23 G 3/4" x 12"	0.6 x 20mm x 300mm	100/900	●
<b>24125190G</b>	Blood Collection Set with Safety Shield 25 G 3/4" x 7.5"	0.5 x 20mm x 190mm	100/900	●
<b>24125300G</b>	Blood Collection Set with Safety Shield 25 G 3/4" x 12"	0.5 x 20mm x 300mm	100/900	●

## BLOOD COLLECTION SETS WITH SAFETY SHIELD + HOLDER

Vacusera Safety Blood Collection Sets are also available with Pre-Attached holder.



Reference Number	Description	Size (mm)	Pack/ Carton	Colour
<b>24221190K</b>	Blood Collection Set with Safety Shield + Holder 21 G 3/4" x 7"	0.8 x 19mm x 180mm	25/500	●
<b>24221300K</b>	Blood Collection Set with Safety Shield + Holder 21 G 3/4" x 12"	0.8 x 19mm x 305mm	25/500	●
<b>24222190K</b>	Blood Collection Set with Safety Shield + Holder 22 G 3/4" x 7"	0.7 x 19mm x 180mm	25/500	●
<b>24222300K</b>	Blood Collection Set with Safety Shield + Holder 22 G 3/4" x 12"	0.7 x 19mm x 305mm	25/500	●
<b>24223190K</b>	Blood Collection Set with Safety Shield + Holder 23 G 3/4" x 7"	0.6 x 19mm x 180mm	25/500	●
<b>24223300K</b>	Blood Collection Set with Safety Shield + Holder 23 G 3/4" x 12"	0.6 x 19mm x 305mm	25/500	●
<b>24225190K</b>	Blood Collection Set with Safety Shield + Holder 25 G 3/4" x 7"	0.5 x 19mm x 180mm	25/500	●
<b>24225300K</b>	Blood Collection Set with Safety Shield + Holder 25 G 3/4" x 12"	0.5 x 19mm x 305mm	25/500	●
<b>24221190G</b>	Blood Collection Set with Safety Shield + Holder 21 G 3/4" x 7,5"	0.8 x 20mm x 190mm	50/400	●
<b>24221300G</b>	Blood Collection Set with Safety Shield + Holder 21 G 3/4" x 12"	0.8 x 20mm x 300mm	50/400	●
<b>24223190G</b>	Blood Collection Set with Safety Shield + Holder 23 G 3/4" x 7,5"	0.6 x 20mm x 190mm	50/400	●
<b>24223300G</b>	Blood Collection Set with Safety Shield + Holder 23 G 3/4" x 12"	0.6 x 20mm x 300mm	50/400	●
<b>24225190G</b>	Blood Collection Set with Safety Shield + Holder 25 G 3/4" x 7,5"	0.5 x 20mm x 190mm	50/400	●
<b>24225300G</b>	Blood Collection Set with Safety Shield + Holder 25 G 3/4" x 12"	0.5 x 20mm x 300mm	50/400	●

## VACUSERA TOURNIQUET

Vacusera Tourniquet is used for tying the vein during blood collection. It is safe and easy to use.



Reference Number	Description	Pack/Carton
<b>259001</b>	Automatic Tourniquet	1 pc / 500 pcs
<b>259001-1</b>	Automatic Tourniquet for children - Green	1 pc / 500 pcs
<b>259001-2</b>	Automatic Tourniquet for children - Pink	1 pc / 500 pcs
<b>259050</b>	Disposable Tourniquet	50 pcs / box

## VACUSERA SHARPS DISPOSAL CONTAINER

For disposal of used sharp objects like cannulas, scalpels, needles, holders, syringes etc. Available in 2.1 lt. and 7.5 lt.



Reference Number	Description	Quantity/Box
<b>101175</b>	Sharps Disposal Container 7.5 lt.	40 pcs / box
<b>101121</b>	Sharps Disposal Container 2.1 lt.	100 pcs / box



# VACUSERA MINI CAPILLARY BLOOD COLLECTION SYSTEM

Vacusera Mini Capillary Blood Collection System provides all the necessary products for pediatric need.

## VACUSERA MINI CAPILLARY BLOOD COLLECTION TUBES

Vacusera Mini Capillary Blood Collection Tubes are designed with safety cap for collecting high quality capillary blood sample.

## VACUSERA MINI SERUM TUBES



Reference Number	Description	Draw vol. (ml)	Additive	Pack /Carton	Cap Colour
<b>238202</b>	VACUSERA MINI 0.2 ml CAT Serum Clot Activator	0.2	Clot Activator	50/1000	●
<b>238205</b>	VACUSERA MINI 0.5 ml CAT Serum Clot Activator	0.5	Clot Activator	50/1000	●
<b>238302</b>	VACUSERA MINI 0.2 ml CAT Serum GEL + Clot Activator	0.2	GEL + Clot Activator	50/1000	●
<b>238305</b>	VACUSERA MINI 0.5 ml CAT Serum GEL + Clot Activator	0.5	GEL + Clot Activator	50/1000	●

## VACUSERA MINI EDTA TUBES



Reference Number	Description	Draw vol. (ml)	Additive	Pack /Carton	Cap Colour
<b>238602</b>	VACUSERA MINI 0.2 ml K2E/K2Edta	0.2	K2E K2Edta	50/1000	●
<b>238605</b>	VACUSERA MINI 0.5 ml K2E/K2Edta	0.5	K2E K2Edta	50/1000	●
<b>238612</b>	VACUSERA MINI 0.2 ml K3E/K3Edta	0.2	K3E K3Edta	50/1000	●
<b>238615</b>	VACUSERA MINI 0.5 ml K3E/K3Edta	0.5	K3E K3Edta	50/1000	●
<b>238625</b>	VACUSERA MINI 0.5 ml K2E/K2Edta (13x75mm)	0.5	K2E K2Edta	100/1000	●

## VACUSERA MINI HEPARIN TUBES



Reference Number	Description	Draw vol. (ml)	Additive	Pack /Carton	Cap Colour
<b>238402</b>	VACUSERA MINI 0.2 ml LH/Lithium Heparin	0.2	LH/Lithium Heparin	50/1000	●
<b>238405</b>	VACUSERA MINI 0.5 ml LH/Lithium Heparin	0.5	LH/Lithium Heparin	50/1000	●
<b>238412</b>	VACUSERA MINI 0.2 ml LH/Lithium Heparin + GEL	0.2	LH/Lithium Heparin+GEL	50/1000	●
<b>238415</b>	VACUSERA MINI 0.5 ml LH/Lithium Heparin + GEL	0.5	LH/Lithium Heparin + GEL	50/1000	●
<b>238422</b>	VACUSERA MINI 0.2 ml NH/Sodium Heparin	0.2	NH/Sodium Heparin	50/1000	●
<b>238425</b>	VACUSERA MINI 0.5 ml NH/Sodium Heparin	0.5	NH/Sodium Heparin	50/1000	●

## VACUSERA MINI GLUCOSE TUBES



Reference Number	Description	Draw vol. (ml)	Additive	Pack /Carton	Cap Colour
<b>238701</b>	VACUSERA MINI 0.2 ml FE/K2Edta	0.2	FE/Sodium Fluoride + K2Edta	50/1000	●
<b>238705</b>	VACUSERA MINI 0.5 ml FE/K2Edta	0.5	FE/ Sodium Fluoride + K2Edta	50/1000	●

## VACUSERA MINI COAGULATION TUBES



Reference Number	Description	Draw vol. (ml)	Additive	Pack /Carton	Cap Colour
<b>238505</b>	VACUSERA MINI 0.5 ml Coagulation Sodium Citrate 3.2%	0.5	Sodium Citrate 3.2%	50/1000	●

## VACUSERA LANCETS

Vacusera Lancets provide consistent puncture depth for easy safe sample collection.



Reference Number	Description	Draw vol. (mm)	Pack / Carton	Cap Colour
2393018N	VACUSERA Pressure activated safety blood lancet 30G/1.8mm	30G/1.8mm	100/1000	●
2393015N	VACUSERA Pressure activated safety blood lancet 30G/1.5mm	30G/1.5mm	100/1000	●
2392818N	VACUSERA Pressure activated safety blood lancet 28G/1.8mm	28G/1.8mm	100/1000	●
2392815N	VACUSERA Pressure activated safety blood lancet 28G/1.5mm	28G/1.5mm	100/1000	●
2392618N	VACUSERA Pressure activated safety blood lancet 26G/1.8mm	26G/1.8mm	100/1000	●
2392518N	VACUSERA Pressure activated safety blood lancet 25G/1.8mm	25G/1.8mm	100/1000	●
2392322N	VACUSERA Pressure activated safety blood lancet 23G/2.2mm	23G/2.2mm	100/1000	●
2392318N	VACUSERA Pressure activated safety blood lancet 23G/1.8mm	23G/1.8mm	100/1000	●
2392128N	VACUSERA Pressure activated safety blood lancet 21G/2.8mm	21G/2.8mm	100/1000	●
2392122N	VACUSERA Pressure activated safety blood lancet 21G/2.2mm	21G/2.2mm	100/1000	●
2392118N	VACUSERA Pressure activated safety blood lancet 21G/1.8mm	21G/1.8mm	100/1000	●
2392118BN	VACUSERA Pressure activated safety blood lancet - Blade 21G/1.8mm	21G/1.8mm	100/1000	●
2391818N	VACUSERA Pressure activated safety blood lancet 18G/1.8mm	18G/1.8mm	100/1000	●
2391818BN	VACUSERA Pressure activated safety blood lancet - Blade 18G/1.8mm	18G/1.8mm	100/1000	●



# VACUSERA SEDIMENTATION SYSTEMS

Vacusera Sedimentation Tubes are consisting 3.2% sodium citrate for ESR test.

## VACUSERA CLOSED SEDIMENTATION SYSTEM

Reference Number	Description	Draw vol. (ml)	Size (mm)	Additive	Shelf life	Label Type	Pack/ Carton	Cap Colour
233903	VACUSERA 1.28 ml Glass ESR Tube	1.28	8 x 120	4NC Sodium Citrate 3.2%	24 months	Paper	100/1000	●
233902	VACUSERA 1.6 ml Glass ESR Tube	1.6	9 x 120	4NC Sodium Citrate 3.2%	24 months	Paper	100/1000	●
290020	VACUSERA 20 ESR analyzer						1/1	
290100	VACUSERA 100 ESR analyzer						1/1	
233901	VACUSERA 1.28 ml & 1.6 ml ESR Rack						1/10	

## VACUSERA OPEN SEDIMENTATION SYSTEM

Reference Number	Description	Draw vol. (ml)	Size (mm)	Additive	Shelf life	Label Type	Pack/ Carton	Cap Colour
234902	VACUSERA 2 ml ESR Tube	2	13 x 75	4NC Sodium Citrate 3.2%	12 months	Paper	100/1200	●
234900	VACUSERA Disposable ESR Pipette				60 months		200/2000	
234901	VACUSERA ESR RACK without graduation for 234902 & 434902 (Vacusera Open Sedimentation System)						1/25	



## VACUSERA URINE COLLECTION SYSTEMS

Vacusera Urine Collection Systems provide easy and comfortable use with urine tubes and integrated urine beaker for healthcare workers.

Reference Number	Description	Draw vol. (ml)	Size (mm)	Additive	Shelf life	Label Type	Pack/Carton	Cap Colour
<b>234814</b>	VACUSERA 4 ml Urine Tube - Boric Acid	4	13 x 75	Boric Acid	18 months	Paper	100/1200	●
<b>235806</b>	VACUSERA 6 ml Urine Tube - No Additive	6	13 x 100	No Additive	18 months	Paper	100/1200	●
<b>236800</b>	VACUSERA 10 ml Urine Tube - No Additive	10	16 x 100	No Additive	18 months	Paper	100/1200	●
<b>235816</b>	VACUSERA 6 ml Urine Tube - Boric Acid	6	13 x 100	Boric Acid	18 months	Paper	100/1200	●
<b>236810</b>	VACUSERA 10 ml Urine Tube - Boric Acid	10	16 x 100	Boric Acid	18 months	Paper	100/1200	●
<b>236828</b>	VACUSERA 8 ml Urine Tube - Chlorhexidine	8	16 x 100	Chlorhexidine	18 months	Paper	100/1200	●
<b>236820</b>	VACUSERA 10 ml Urine Tube - Chlorhexidine	10	16 x 100	Chlorhexidine	18 months	Paper	100/1200	●
<b>434814</b>	VACUSERA 4 ml Urine Tube - Boric Acid	4	13 x 75	Boric Acid	18 months	Transparent	100/1200	●
<b>435806</b>	VACUSERA 6 ml Urine Tube - No Additive	6	13 x 100	No Additive	18 months	Transparent	100/1200	●
<b>436800</b>	VACUSERA 10 ml Urine Tube - No Additive	10	16 x 100	No Additive	18 months	Transparent	100/1200	●
<b>435816</b>	VACUSERA 6 ml Urine Tube - Boric Acid	6	13 x 100	Boric Acid	18 months	Transparent	100/1200	●
<b>436810</b>	VACUSERA 10 ml Urine Tube - Boric Acid	10	16 x 100	Boric Acid	18 months	Transparent	100/1200	●
<b>436828</b>	VACUSERA 8 ml Urine Tube - Chlorhexidine	8	16 x 100	Chlorhexidine	18 months	Transparent	100/1200	●
<b>436820</b>	VACUSERA 10 ml Urine Tube - Chlorhexidine	10	16 x 100	Chlorhexidine	18 months	Transparent	100/1200	●
<b>103023</b>	VACUSERA Urine Beaker with Integrated Holder 100 ml (Nonsterile)	100		No Additive	36 months		300	●
<b>103026</b>	VACUSERA Urine Beaker with Integrated Holder 100 ml in a single bag (Sterile)	100		No Additive	36 months		300	●
<b>103033</b>	VACUSERA 24 Hourly Integrated Urine Collection Cap 3L	3000			60 months		14	●
<b>236839</b>	VACUSERA 9 ml Urine Tube – No Additive – Conical Bottom	9	16 x 100	No Additive	18 months	Paper	100/1200	●
<b>236848</b>	VACUSERA 8 ml Urine Tube – Boric Acid – Conical Bottom	8	16 x 100	Boric Acid	18 months	Paper	100/1200	●
<b>236859</b>	VACUSERA 9 ml Urine Tube – Chlorhexidine – Conical Bottom	9	16 x 100	Chlorhexidine	18 months	Paper	100/1200	●

## VACUSERA BLOOD COLLECTION SYSTEMS ORDER OF DRAW



DRAW VOL	COLOR CODE	TUBE TYPE	DESCRIPTION	MIXING	CENTRIFUGE SPEED & TIME
1 ml / 1.8 ml 2.7 ml / 3.6 ml / 4.5 ml		SODIUM CITRATE	COAGULATION TEST	3-4	2000-2500 g (RCF) 10 -15 MIN
1.28 ml / 1.6 ml / 2 ml		ESR	SEDIMENTATION TEST	3-4	
6 ml / 9 ml		ACD	BLOOD GROUPING	3-4	
1 ml / 2 ml / 3 ml / 4 ml 6 ml / 9 ml / 10 ml		CLOT ACTIVATOR	SERUM TEST	5-6	1300 g (RCF) 10 MIN
2 ml / 2.5 ml / 3.5 ml 5 ml / 8 ml		CLOT ACTIVATOR + GEL	SERUM TEST	5-6	2000-3000 g (RCF) 10 -15* MIN
5 ml		CLOT ACTIVATOR THROMBIN + GEL	SERUM TEST	5-6	2000-3000 g (RCF) 10 -15* MIN
2 m / 4 ml / 6 ml / 9 ml		LITHIUM HEPARIN SODIUM HEPARIN	PLASMA TEST	8-10	1300 g (RCF) 10 MIN
3 ml / 5 ml / 8 ml		LITHIUM HEPARIN + GEL SODIUM HEPARIN + GEL	PLASMA TEST	8-10	1300-2000 g (RCF) 10 MIN
1 ml / 2 ml / 3 ml / 4 ml 4.5 ml / 6 ml / 9 ml		EDTA	HAEMATOLOGY TEST	8-10	
3 ml / 5 ml / 8 ml		EDTA + GEL	MOLECULAR DIAGNOSTIC	8-10	1100-1500 g (RCF) 10 MIN
6 ml / 9 ml		CROSS MATCH CLOT ACTIVATOR	CROSS MATCH TEST	5-6	1300 g (RCF) 10 MIN
4 ml / 6 ml		CROSS MATCH K2EDTA / K3EDTA	CROSS MATCH TEST	8-10	
2 ml / 4 ml		FE / SODIUM FLUORIDE + EDTA	GLUCOSE TEST	8-10	1300 g (RCF) 10 MIN
2 ml / 4 ml		FX/ SODIUM FLUORIDE + POTASSIUM OXALATE	GLUCOSE TEST	8-10	1300 g (RCF) 10 MIN
6 ml		TRACE ELEMENT CLOT ACTIVATOR	TRACE ELEMENT TEST	5-6	1300 g (RCF) 10 MIN
6 ml		TRACE ELEMENT NH/SODIUM HEPARIN	TRACE ELEMENT TEST	8-10	1300 g (RCF) 10 MIN
6 ml		TRACE ELEMENT K2EDTA	TRACE ELEMENT TEST	8-10	

Insufficient blood volume and mixing properly can effect the test results and may cause re-collection of blood.

\* With fixed-angle rotors 15 minutes - With swing-out rotors 10 minutes



 **VACUSERA**



[www.disera.com.tr](http://www.disera.com.tr)

**disera**  
RESULTS OF THE SCIENTIFIC PROCESS

Disera Tıbbi Malzeme Lojistik Sanayi ve Ticaret A.Ş.  
Head Office: 5758 Sok. No:4 H/11 P.K. 35110 / Karabağlar - İZMİR / TÜRKİYE  
Factory: İbni Melek O.S.B Mah. Tosbi Yol 5 Sk. No: 46 Tire - İZMİR / TÜRKİYE  
Phone: +90 (232) 264 66 68 Fax: +90 (232) 264 84 00  
www.disera.com.tr - www.vacusera.com